

DEPARTMENT OF THE ARMY TECHNICAL MANUAL

ORGANIZATIONAL, DIRECT SUPPORT, AND GENERAL
 SUPPORT MAINTENANCE REPAIR PARTS AND SPECIAL
 TOOLS LIST (INCLUDING DEPOT MAINTENANCE REPAIR
 PARTS AND SPECIAL TOOLS)

FOR

MECHANISM, VALVE REPLACEMENT, M1

FSN 494036"190

Current as of 29 February 1972

Headquarters, Department of the Army, Washington, D.C.
 25 April 1972

Section		Page	Illus. Figure
I.	INTRODUCTION	1	
II.	REPAIR PARTS LIST	5	1, 2, 3, 4, 5
III.	SPECIAL TOOLS LIST - Not applicable		
IV.	REPAIR PARTS LIST.....	7	1, 2, 3, 4, 5
V.	SPECIAL TOOLS LIST - Not applicable		
VI.	FEDERAL STOCK NUMBER AND REFERENCE NUMBER INDEX..	14	

SECTION I. INTRODUCTION

1. Scope

This manual lists repair parts required for the performance of organizational, direct support, general support, and depot maintenance of the M1 valve replacement mechanism.

authorized at the direct support, general support, and depot levels for the performance of maintenance. The list also includes parts which must be removed for the replacement of the authorized parts. Parts are listed in figure and item number sequence.

2. General

This Repair Parts and Special Tools List is divided into the following sections:

a. Repair Parts List-Section II. A list of repair parts authorized at the organizational level for the performance of maintenance. The list also includes parts which must be removed for replacement of the authorized parts. Parts are listed in figure and item number sequence.

d. *Special Tools List--Section V. Not applicable.*

e. *Federal Stock Number and Reference Number Index--Section VI. A list, in ascending numerical sequence, of all Federal stock numbers appearing in the listings, followed by a list, in alphameric sequence, of all reference numbers appearing in the listings. Federal stock numbers and reference numbers are cross-referenced to each illustration figure and item number appearance.*

b. *Special-Tools List--Section III. Not applicable.*

c. *Repair Parts List--Section IV. A list of repair parts*

This manual supersedes TM 3-4940-200-25P, 7 February 1963.

the tabular listings:

a. *Source, Maintenance, and Recoverability Codes (SMR), (5 Positions).*

(1) *Source codes (positions 1 and 2).* Indicates the source for the listed items. Source code are:

<i>Code</i>	<i>Explanation</i>
PA	Item procured and stocked for anticipate or known usage.
PB	Item procured and stocked for insurance purposes because essentiality dictate that a minimum quantity be available i the supply systems.
PC	Item procured and stocked and which otherwise would be coded PA except that it deteriorative in nature.
PD	Support item, excluding support equipment procured for initial issue or outfitting an stocked only for subsequent or additional initial issues or outfittings. Not subject t automatic replenishment.
PE	Support equipment procured and stocked for initial issue or outfitting to specified maintenance repair activities.
PF	Support equipment which will not be stocked but which will be centrally procured o demand.
PG	Item procured and stocked to provide for sustained s for the life of t? equipment It is applied to an item peculiar to the equipment which because, of probable discontinuance or shutdown of production facilities would prove un-economical to reproduce at a later time KD An item of depot overhaul/repair kit an not purchased separately. Depot kit d fined as a kit that provides items require at the time of overhaul or repair.
KF	An item of a maintenance kit and not pur- chased separately. Maintenance kit d fined as a kit that provides an item that can be replaced at organizational or in- termediate levels of maintenance.
KB	Item included in both a depot overhaul/r pair kit and a maintenance kit.
MO	Item to be manufactured or fabricated organizational level.
MF	Item to be manufactured or fabricated the direct support maintenance level.
MH	Item to be manufactured or fabricated E the general support maintenance level.
MD	Item to be manufactured or fabricated E depot maintenance level.
AO	Item to be assembled at organization level.
AF	Item to be assembled at the direct support maintenance level.
AH	Item to be assembled at the general support maintenance level.
AD	Item to be assembled at depot maintenance levels.

<i>Code</i>	<i>Explanation</i>
XA	Item is not procured or stocked because the requirements for the item will result in the replacement of the next higher assembly.
XB	Item is not procured or stocked. If not available through salvage, requisition.
XC	Installation drawing, diagram, instruction sheet, field service drawing, that is identified by manufacturers' part number.

NOTE

Cannibalization or salvage may be used as a source of supply for any items source coded above except those coded XA and aircraft support items as restricted by AR 700-42.

(2) Maintenance codes (positions 3 and 4).

(a) *Position 3.* The maintenance code entered in third position indicates the lowest maintenance level authorized to remove, replace, and use the support item. Capabilities of higher maintenance categories are considered equal or better. Maintenance codes are:

<i>Code</i>	<i>Explanation</i>
C	Crew/operator
O	Organizational maintenance
F	Direct support maintenance
H	General support maintenance
D	Depot maintenance

(b) *Position 4.* The maintenance code entered in the fourth position indicates whether the item is to be repaired and identifies the lowest maintenance level with the capability to perform complete repair (i.e., all authorized maintenance functions). Capabilities of higher maintenance categories are considered equal or better. Maintenance codes are:

<i>Code</i>	<i>Explanation</i>
O	Organizational maintenance
F	Direct support maintenance
H	General support maintenance
D	Depot maintenance
Z	Non-reparable. No repair is authorized

(3) *Recoverability code (position 5).* Indicates whether unserviceable items should be returned for recovery or salvage. Recoverability codes are:

<i>Code</i>	<i>Explanation</i>
Z	Non-reparable item. When unserviceable, condemn and dispose at the level indicated in position 3.
F	Reparable item. When uneconomically repairable, condemn and dispose at the direct support level.
H	Reparable item. When uneconomically repairable, condemn and dispose at the general support level.
D	Reparable item. When beyond lower level repair capability, return to depot. Condemnation and disposal not authorized below depot level.

<i>Code</i>	<i>Explanation</i>
L.....	Reparable item. Repair, , condemnation, and disposal not authorized below depot/Specialized Repair Activity level.
A.....	Item requires special handling or condemnation procedures because of specific reasons (i e, precious metal content, high dollar value, critical material or hazardous material). Refer to appropriate manuals/directives for specific instructions.

b. Federal Stock Number. Indicates the Federal stock number assigned to the item and will be used for requisitioning purposes.

c. Description. Indicates the Federal item name and a minimum description required to identify the item. The last line indicates the reference number followed by the applicable Federal Supply Code for Manufacturer (FSCM) in parentheses. The FSCM is used as an element in item identification to designate manufacturer for distributor or Government agency, etc., and is identified in SB 708-42.

d. Unit of Measure (U/M). Indicates the standard or basic quantity by which the listed item is used in performing the actual maintenance function. This measure is expressed by a two character alphabetical abbreviation, e.g., ea, in., pr, etc., and is the basis used to indicate quantities and allowances in subsequent columns. When the unit of measure differs from the unit of issue, the lowest unit of issue that will satisfy the required units of measure will be requisitioned.

e. Quantity Incorporated in Unit. Indicates the quantity of the item used in the breakout shown on the illustration figure. A "V" appearing in this column in lieu of a quantity indicates that no specific quantity is applicable, e.g., shims, spacers, etc.

f. 15-Day Organizational Maintenance Allowances.
 (1) An asterisk (*) entered in the allowance subcolumns indicates that the repair parts is authorized for use at the organizational level, and will be requisitioned on an "as required" basis until stockage is based on demand in accordance with AR 710-2.

(2) Major Army commanders are authorized to approve reductions in the range of support items authorized for use in units within their commands. Recommendations for increases, in range of items authorized for use, should be forwarded to the Commanding Officer, Edgewood Arsenal, ATTN: SMUEA-DE-ETL, Edgewood Arsenal, Md. 21010, for action on such recom-

mendations Changes approved will be reflected in a revision to the manual.

g. 30-Day DS/GS Maintenance Allowances

(1) An asterisk (*) entered in the direct support (DS) and/or general support (GS) subcolumns indicates that the repair part is authorized for use at that level, and will be requisitioned on an "as required" basis.

(2) The repair parts authorized at the DS/ GS levels are for the maintenance mission at these levels.

(3) Requirements for repair parts stockage and for distribution to supported units will be based on demand and determined In accordance with AR 710-2.

h. 1-Year Allowances Per 100 Equipments/ Contingency Planning Purposes. An asterisk (*) entered in this column indicates that the total quantity of the repair part required for distribution and contingency planning purposes will be based on demand data.

i. Depot Maintenance Allowance Per 100 Equipments. An asterisk (*) entered in this column indicates that the repair part is authorized for use at the depot level, and will be requisitioned on an "as required" basis.

j. Illustration. This column is divided as follows:

(1) *Figure number.* Indicates the figure number of the illustration on which the item is shown.

(2) *Item number.* Indicates the callout number used to reference the item on the illustration.

4. Special Information

a. Action change codes indicated in the left-hand margin of the listing page denote the following:

N-Indicates an added item.

C-Indicates a change in data.

R-Indicates a change in FSN only.

b. The following publication pertains to the M1 valve replacement mechanism:

TM 3-4940-200-15 ... Operators, Organizational, Direct Support, General Support, and Depot Maintenance Manual.

5. How to Locate Repair Parts

a. When Federal stock number or reference number is unknown:

(1) *First.* Find the illustration on which the repair part is shown and note the illustration figure and item number of the repair part.

(2) *Second.* Using the Repair Parts Listing, locate the illustration figure and item number noted on the illustration.

b. When Federal stock number or reference number is known:

(1) *First* Using the Index of Federal Stock Numbers and Reference Numbers, find the pertinent Federal stock number or reference number. This index is in ascending FSN sequence, followed by a list of reference numbers in ascending alphameric sequence, cross-referenced to the illustration figure number and item number.

(2) *Second.* Using the Repair Parts Listing, find the illustration figure number and item number

referenced in the Index of Federal Stock Numbers and Reference Numbers.

6. Abbreviations

Not applicable

Reporting of Equipment Publication Improvements

The reporting of errors, omissions, and recommendations for improving this publication should be submitted on DA Form 2028 (Recommended changes to publications) and forwarded direct to Officer, Edgewood Arsenal, ATTN: SMUEA-DEETL, Edgewood Arsenal, Md. 21010.

SECTION II REPAIR PARTS LIST

Action	(1) SMR CODE	(2) FEDERAL STOCK NUMBER	(3) DESCRIPTION REFERENCE NUMBER & MFR CODE USABLE ON CODE		(4) UNIT OF MEAS	(5) QTY INC IN UNIT	(6) 15-DAY ORGANIZATIONAL MAINTENANCE ALW				(7) ILLUSTRATION	
							(a) 1-5	(b) 6-20	(c) 21-50	(d) 51-100	(a) FIGURE NO.	(B) ITEM NO.
							C	PA OZ Z	5305-269-3213	SCREW, CAP, HEXAGON HEAD stl pltd, % in.-16 UNC-2A	ea	1
C	PA OZ Z	5310-732-0558	NUT, PLAIN, HEXAGON HEAD stl pltd, % in-16 UNC-2B MS90725-62 (96906)	ea	1	*	*	*	*	1	2	
C	PA OZ Z	5310-934-9758	NUT, PLAIN, HEXAGON stl pltd, 10-24 UNC-2B MS519678 (96906)	ea	8	*	*	*	*	2	1	
C	PA OZ Z	4940-598-3952	SPRING, HELICAL, COMPRESSION stl, 1 3/16 in. o/a lg, %2 in. od, 12 coils MS35649-202 (96906)	ea	1	*	*	*	*	2	2	
C	PA OZ Z	4940-368-6235	PLUNGER, LEVER LOCK A6-15-69 (81361)	ea	1	*	*	*	*	2	3	
C	PA OZ Z	5305-368-6231	SCREW, BALL A615-62 (81361)	ea	3	*	*	*	*	2	4	
C	PA OZ Z	5305-254-8846	SCREW, LUG stl hd knurled, e in.-13 NC, 2 1/16 in. lg A6-15-33 (81361)	ea	2	*	*	*	*	2	5	
C	PA OZ Z	5310-732-0558	NUT, PLAIN, HEXAGON stl pltd, % in.-16 UNC-2B A6-1532 (81361)	ea	6	*	*	*	*	2	6	
C	PA OZ Z	4940-314-0783	CAP, SOCKET MS51967-8 (96906)	ea	4	*	*	*	*	2	7	
C	PA OZ Z	5306-530-9247	BOLT, MACHINE stl, % in-16 UNC-2A B615-82 (81361)	ea	12	*	*	*	*	2	8	
C	PA OZ Z	4010-952-2808	CHAIN, WELDED stl, 1 1/16 in size, 9 % links per ft, 8419%2 In. lg o/a MIL-B-857 (81349)	ea	2	*	*	*	*	2	9	
C	PA OZ A	4940-598-6917	SPRING, HELICAL, COMPRESSION stl, 7/16 in o/a lg, 1 % iLn od A615-90 (81361)	ea	2	*	*	*	*	2	10	
C	PA OZ Z	5315-368-6234	PIN, GROOVED, HEADED A6-15-23 (81361)	ea	1	*	*	*	*	2	11	
C	PA OZ Z	4940-335-5471	COLLAR, YOKE A6-15-61 (81361)	ea	2	*	*	*	*	2	12	
C	PA OZ Z	4940-368-6404	LEVER, VALVE SOCKET B6-15-56 (81361)	ea	1	*	*	*	*	2	13	

Action	(1) SMR CODE	(2) FEDERAL STOCK NUMBER	(3) DESCRIPTION REFERENCE NUMBER & MFR CODE USABLE ON CODE		(4) UNIT OF MEAS	(5) QTY INC IN UNIT	(6) 15-DAY ORGANIZATIONAL MAINTENANCE ALW				(7) ILLUSTRATION	
							(a) 1-5	(b) 6-20	(c) 21-50	(d) 51-100	(a) FIGURE NO.	(B) ITEM NO.
C	PA OZ Z	4940-368-6298	COUPLING, ADJUSTABLE, CHAIN		ea	2	*	*	*	*	2	14
C	PA OZ Z	6310-768-0318	NUT, PLAIN, HEXAGON stl pltd, in -13 UNC-2B C6-15-72 (81361)		ea	2	*		*	*	3	1
C	PA OZ Z	5120368-6400	WRENCH, SOCKET single socket, T type, fixed handle, sq shape socket, 0.697 in size, 11 5/ in. lg MS51967-14 (96906)		ea	1	*	*	*	*	3	2
C	PA OZ Z	5120368-401	WRENCH, SOCKET socket, 0.697 in size, 11 5/ in. lg single socket, T type, fixed handle, sq shape B6-15-21 (81361)		ea	1	*	*	*	*	3	3
C	PA OZ Z	6306984-6215	SCREW, MACHINE stl pltd, pan head, 1024 UNC2A, 1' in. lg B-15-26 (81361)		ea	8	*	*	*	*	3	4
C	PA OZ Z	4940-314-0812	CLAMP, KEY socket, 0.697 in size, 11 5/ in. lg MS35206-268 (96906)		ea	8	*	*	*	*	3	5
C	PA OZ Z	5305-368-6224	SCREW, ADJUSTING A6-15-8 (81361)		ea	4	*	*	*	*	3	6
C	PA OZ Z	4940-368-6226	BOLT, LOCK A615-6 (81361)		ea	1	*	*		*	4	3
C	PA OZ Z	4940 368-6229	SPRING, HELICAL, COMPRESSION socket, 0.697 in size, 11 5/ in. lg A6-15-17 (81361)		ea	1	*	*	*	*	4	4
C	PA OZ Z	4940-314-4796	LUG, BALL A615-24 (81361)		ea	1	*	*	*	*	4	5
C	PA OZ Z	5306-206-4769	BOLT, MACHINE socket, 0.697 in size, 11 5/ in. lg B6-15-58 (81361)		ea	2	*	*	*	*	4	6
C	PA OZ Z	4940368-6406	SOCKET, OLD VALVE FF-B-571 (81348)		ea	1	*	*	*	*	5	1
C	PA OZ Z	4940-368-6407	SOCKET, NEW VALVE B6-1543- (81361)		ea	1	*	*	*	*	5	2
C	PA OZ Z	5120-277-9517	WRENCH, OPEN END, FIXED stl, 9/1 in. and % in. openings GGG-W 00636 (81348)		ea	1	*	*	*	*		

Action	(1) SMR CODE	(2) FEDERAL STOCK NUMBER	(3) DESCRIPTION REFERENCE NUMBER & MFR CODE USABLE ON CODE		(4) UNIT OF MEAS	(5) QTY INC IN UNIT	(6) 15-DAY ORGANIZATIONAL MAINTENANCE ALW				(7) ILLUSTRATION	
							(a) 1-5	(b) 6-20	(c) 21-50	(d) 51-100	(a) FIGURE NO.	(B) ITEM NO.
C	PA OZ Z	5305-269-3213	SCREW, CAP, HEXAGON HEAD stl pltd, % in.-16 UNC-2A		ea	1	*	*	*	*	1	1
C	PA OZ Z	5310-732-0558	NUT, PLAIN, HEXAGON HEAD stl pltd, % In-IG UNC-2B MS9072562 (96906)		ea	1	*	*	*	*	1	2
C	PA OZ Z	5310-934-9758	NUT, PLAIN, HEXAGON stl pltd, 10-24 UNC-2B MS51967-8 (96906)		ea	8	*	*	*	*	2	1
C	PA OZ Z	4940-598-3252	SPRING, HELICAL, COMPRESSION stl, 1 3/8 In. o/a lg, %92 In. od, 12 colls MS35649-202 (96906)		ea	1	*	*	*	*	2	2
C	PA OZ Z	4940-3686235	PLUNGER, LEVER LOCK A6-15-69(81361)		ea	1	*	*	*	*	2	3
C	PA OZ Z	5305-368-6231	SCREW, BALL A6-15-62 (81361)		ea	3	*	*	*	*	2	4
C	PA OZ Z	5305-2548846	SCREW, LUG stl hd knurled, M in.-13 NC, 2 ly16 in. lg A6-1533 (81361)		ea	2	*	*	*	*	2	5
C	PA OZ Z	5310-732-0558	NUT, PLAIN, HEXAGON stl, 1 3/8 In. o/a lg, %92 In. od, 12 colls A6-15-32 (81361)		ea	6	*	*	*	*	2	6
C	PA OZ Z	4940-314-0783	CAP, SOCKET MS51967-8 (96906)		ea	4	*	*	*	*	2	7
C	PA OZ Z	5306-530-9247	BOLT, MACHINE stl, D in.-16 UNC-2A B6-15-82 (81361)		ea	12	*	*	*	*	2	8
C	PA OZ Z	4010-952-2808	CHAIN, WELDED stl, 11/4 In. size, 9% links MIL-B-857 (81349)		ea	2	*	*	*	*	2	9
C	PA OZ Z	4940-598-6917	SPRING, HELICAL COMPRESSION stl, 7 9/16 In o/a lg, 1% in. od A6-15-90 (81361)		ea	2	*	*	*	*	2	10
C	PA OZ Z	531-368-6234	PIN, GROOVED, HEADED A6-15-23 (81361)		ea	1	*	*	*	*	2	11
C	PA OZ Z	4940335-471	COLLAR, YOKE A6-15-61 (81361)		ea	2	*	*	*	*	2	12
C	PA OZ Z	4940-366-404	LEVER, VALVE SOCKET B6-15-56 (81361)		ea	1	*	*	*	*	2	13

SECTION II REPAIR PARTS LIST

Action	(1) SMR CODE	(2) FEDERAL STOCK NUMBER	(3) DESCRIPTION REFERENCE NUMBER & MFR CODE USABLE ON CODE		(4) UNIT OF MEAS	(5) QTY INC IN UNIT	(6) 15-DAY ORGANIZATIONAL MAINTENANCE ALW				(7) ILLUSTRATION	
							(a) 1-5	(b) 6-20	(c) 21-50	(d) 51-100	(a) FIGURE NO.	(B) ITEM NO.
							C	PA OZ Z	4940-368-6298	COUPLING, ADJUSTABLE, CHAIN C6-15-72 (81361)		ea
C	PA OZ Z	5310-768-0318	NUT, PLAIN, HEXAGON stl pltd, 1/2 Inn-13 UNC-2B MS51967-14 (96906)		ea	2	*	*	*	*	3	1
C	PA OZ Z	5120-368-6400	WRENCH, SOCKET single socket, T type, fixed handle, sq shape socket, 0.697 in size, all Yil, in. lg B6-15-21 (81361)		ea	1	*	*	*	*	3	2
C	PA OZ Z	612-368-6401	WRENCH, SOCKET single socket, T type, fixed handle, sq shape socket, O 697 In. size, 1% in. lg B6-15-26 (81361)		ea	1	*	*	*	*	3	3
C	PA OZ Z	5306-984-6215	SCREW, MACHINE stl pltd, pan head, 10-24 UNC-2A, 1/16 in. lg MS35206-268 (96906)		ea	8	*	*	*	*	3	4
C	PA OZ Z	4940-314-0812	CLAMP, KEY stl, 1 In. lg, % In. W, y, in. thk A6-15-8 (81361)		ea	8	*	*	*	*	3	5
C	PA OZ Z	5305-368-6224	SCREW, ADJUSTING A6-15-6 (81361)		ea	4	*	*	*	*	3	6
C	PA FZ Z	3040-314-0810	COLLAR, SHAFT stl, Ylo In. bore dia, % In. od, %6 in. axial lg, YIG In. radius A6-15-19 (81361)		ea	1	*	*	*	*	4	1
C	PA FZ Z4	4940-598-3961	SPRING, HELICAL, COMPRESSION stl, %2 in. o/a lg, 0.260 In. od, 10 coils A6-15-25 (81361)		ea	1	*	*	*	*	4	2
C	PA OZ Z	4940-368-6226	BOLT, LOCK A6-15-17 (81361)		ea	1	*	*	*	*	4	3
C	PA OZ Z	4940-368-6229S	PRING, HELICAL, COMPRESSION stl, 1%2 in. o/a lg, 7/16 od, 18 coils A6-15-24 (81361)		ea	1	*	*	*	*	4	4
C	PA OZ Z	4943-144-0796	LUG, BALL B6-158 (81361)		ea	1	*	*	*	*	4	5
C	PA OZ Z	5306-206 4769	BOLT, MACHINE stl pltd, % In.-11b UTNCG2A, 1% iD lg FF-B-571 (81348)		ea	2	*	*	*	*	4	6
C	PA OZ Z	4940-368-6406	SOCKET, OLD VALVE B6-15-83 (81361)		ea	1	*	*	*	*	5	1

Action	(1) SMR CODE	(2) FEDERAL STOCK NUMBER	(3) DESCRIPTION REFERENCE NUMBER & MFR CODE USABLE ON CODE	(4) UNIT OF MEAS	(5) QTY INC IN UNIT	(6) 15-DAY ORGANIZATIONAL MAINTENANCE ALW				(7) ILLUSTRATION	
						(a) 1-5	(b) 6-20	(c) 21-50	(d) 51-100	(a) FIGURE NO.	(B) ITEM NO.
						C	PA OZ Z	4940-368-6407	SOCKET. NEW VALVE B6-1642 (81361)	ea	1
C	PA OZ Z	5120-277-9517	WRENCH, OPEN END FIXED stl, 9/16 in. And 3/4 in. openings GGG-W-0036 (81348)	ea	1	*	*	,	*		

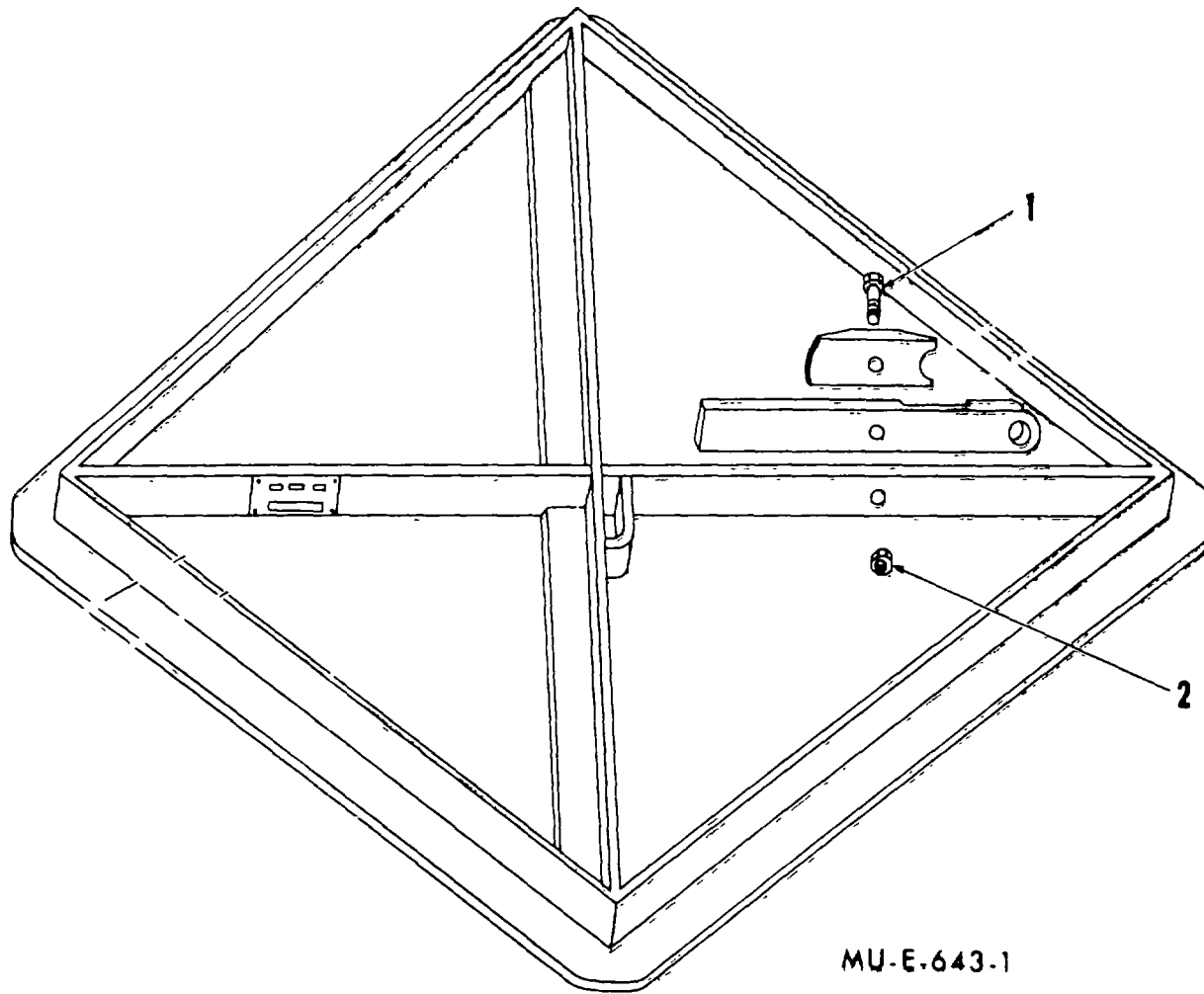
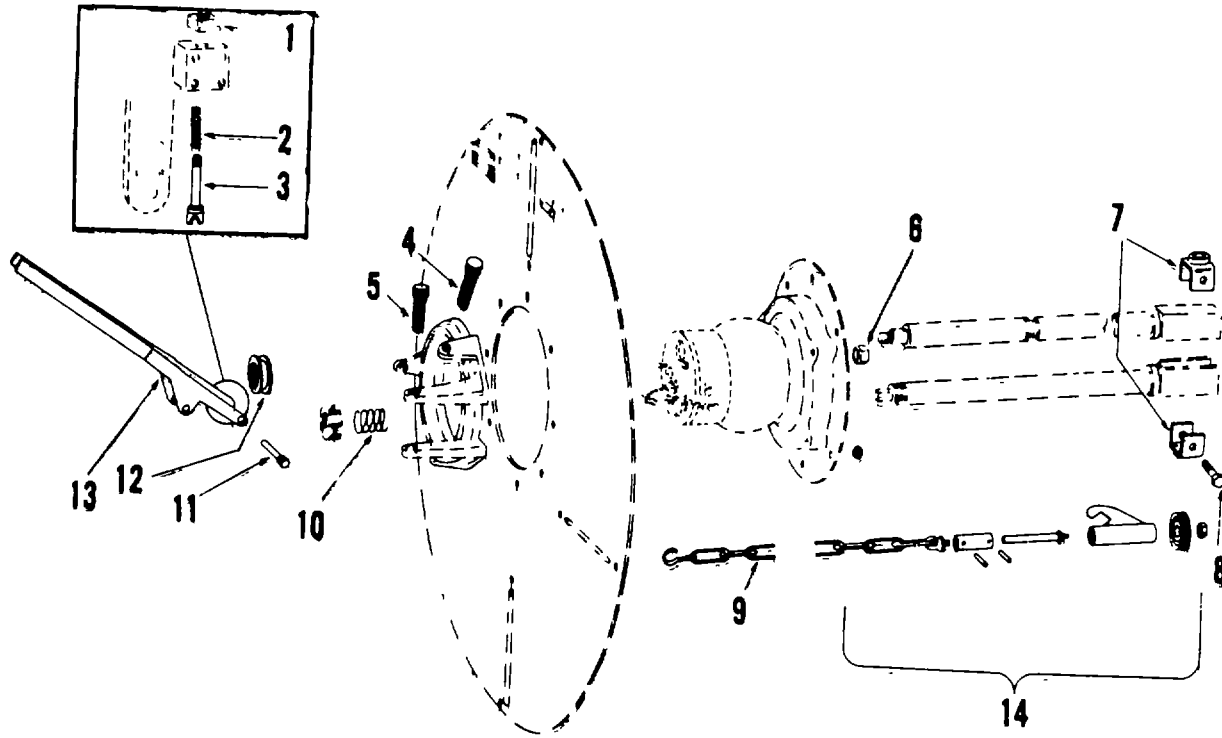
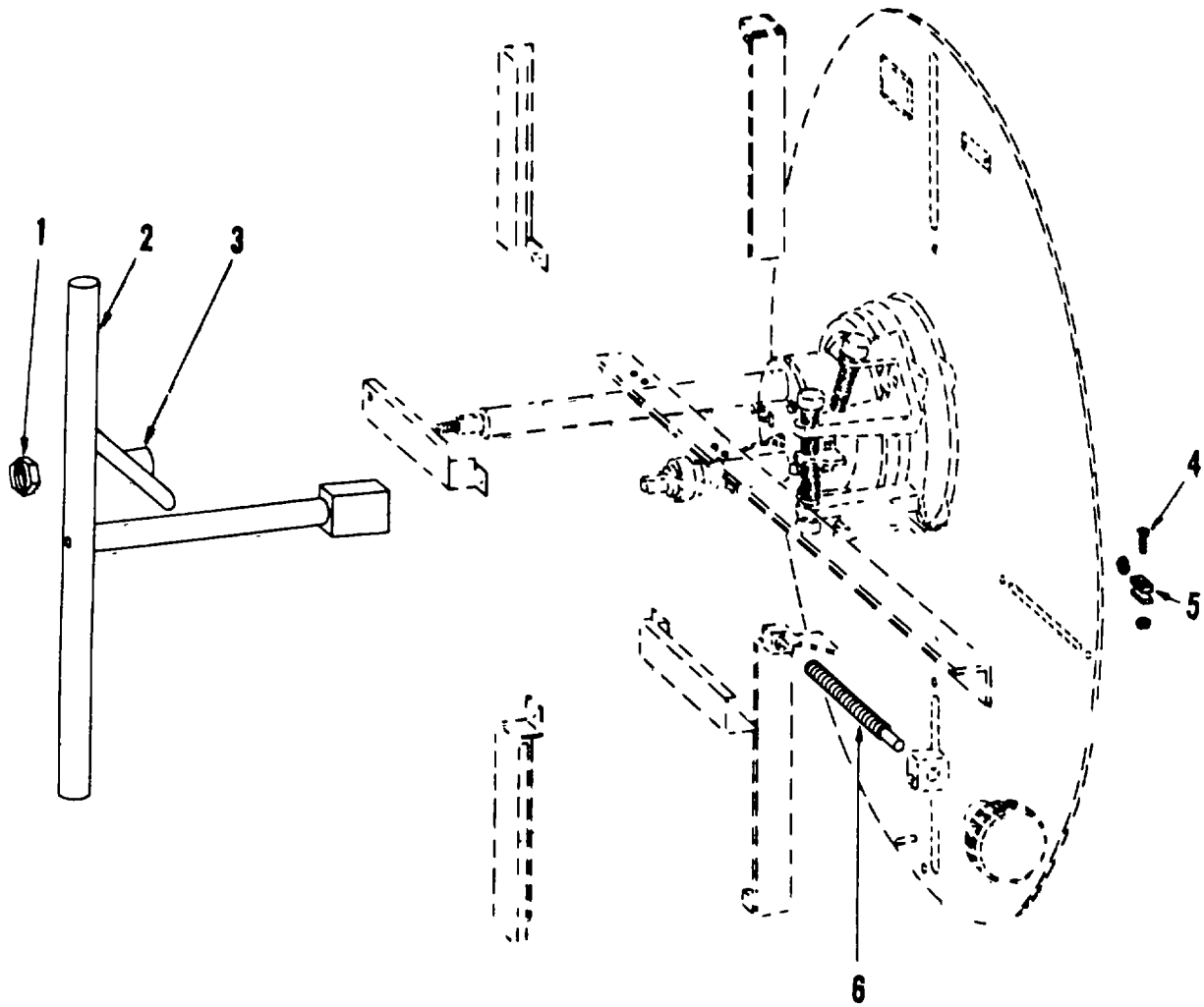

Figure 1. Gage Container



MU-E-643-2

Figure 2 . Repair Parts



MU-E-643-3

Figure 3 . Repair Parts

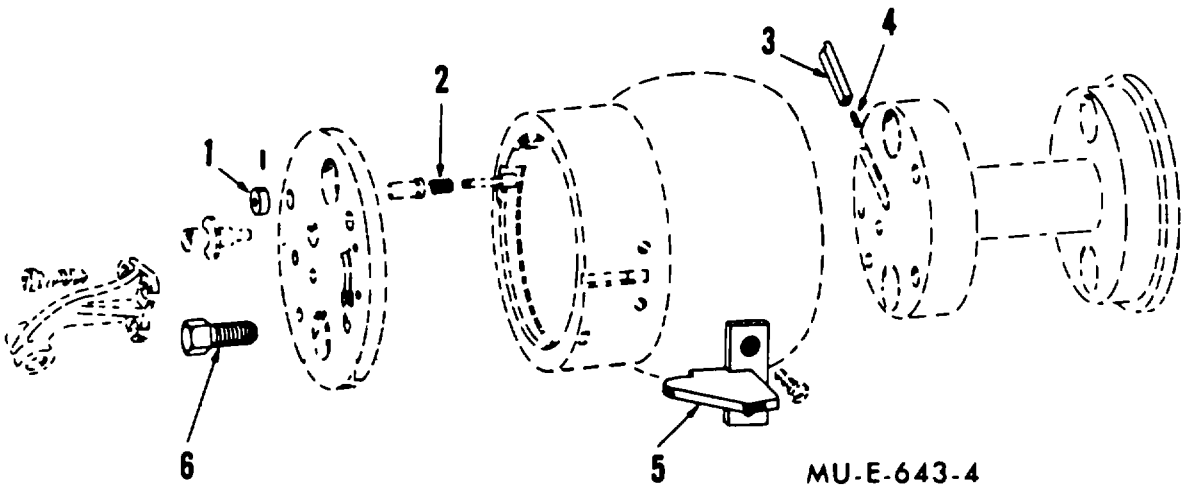

Figure 4. Repair parts

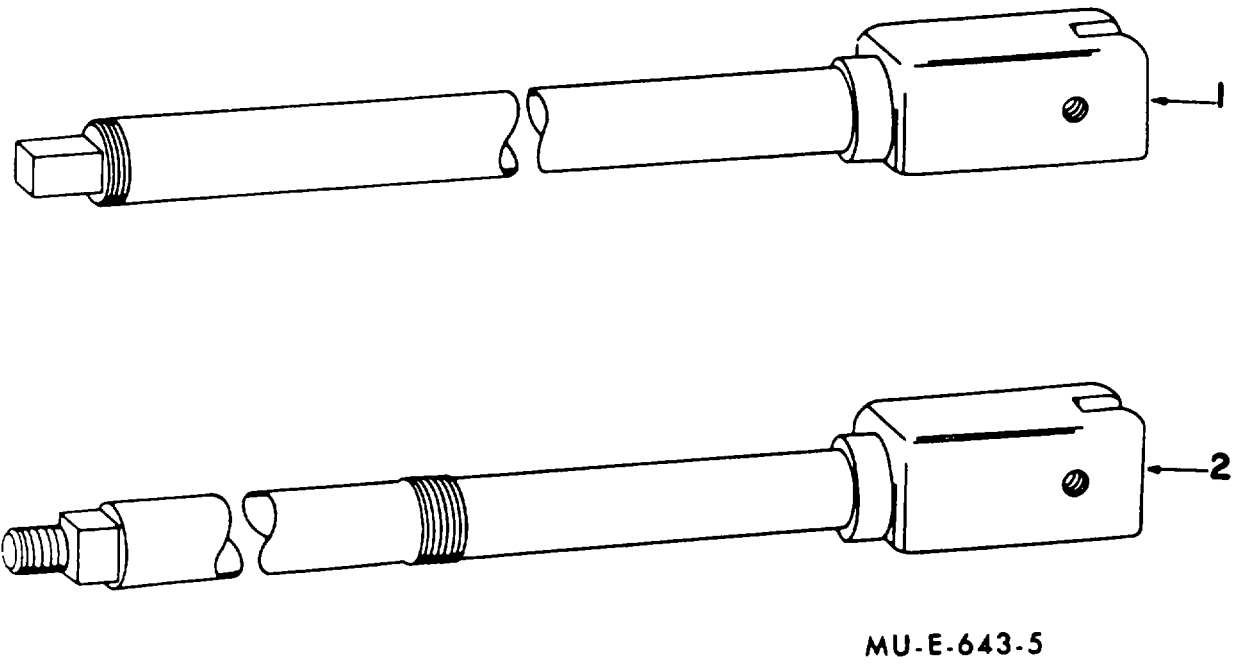

Figure 5. Sockets

**Section VI. INDEX-FEDERAL STOCK NUMBER AND REFERENCE NUMBER
CROSS-REFERENCE TO FIGURE AND ITEM NUMBER**

<i>Stock Number</i>	<i>Figure No.</i>	<i>Item No.</i>	<i>Stock Number</i>	<i>Figure No.</i>	<i>Item No.</i>
3040-314-0810	4	1	5120-277-9517	--	--
4010-952-2808	2	9	5120-368-6400	3	2
4940-314-0783	2	7	5120-368-6401	3	3
4940-314-0796	4	5	5305-254-8846	2	5
4940-314-0812	3	5	5305-269-3213	1	1
4940-335-5471	2	12	5305-368-6224	3	6
4940-368-6226	4	3	5305-368-6231	2	4
4940-368-6229	4	4	5305-984-6215	3	4
4940-368-6235	2	3	5306-206-4769	4	6
4940-368-6298	2	14	5306-530-9247	2	8
4940-368-6404	2	13	5310-732-0558	1	2
4940-368-6406	5	1		2	6
4940-368-6407	5	2	5310-768-0318	3	1
4940-598-3952	2	2	5310-934-9758	2	1
4940-598-3961	4	2	5315-368-6234	2	11
4940-598-6917	2	10			

**Section VI. INDEX-FEDERAL STOCK NUMBER AND REFERENCE NUMBER
CROSS-REFERENCE TO FIGURE AND ITEM NUMBER**

<i>Reference No.</i>	<i>Mfg Code</i>	<i>Fig. No.</i>	<i>Item No.</i>	<i>Reference No.</i>	<i>Mfr. Code</i>	<i>Fig. No.</i>	<i>Item. No.</i>
A6-15-17	81361	4	3	B6-15-56	81361	2	13
A6-15-19	81361	4	1	B6-15-58	81361	4	5
A6-15-23	81361	2	10	B6-15-82	81361	2	7
A6-15-24	81361	4	4	B615-83	81361	5	1
A6-15-25	81361	4	2	B6-15-92	81361	5	2
A6-15-27	81361	2	12	C6-15-72	81361	2	14
A6-15-32	81361	2	5	FF-B-571	81348	4	6
A6-15-6	81361	3	6	MILB-857	81349	2	8
A6-15-33	81361	2	4	GGG-W-00636	81348	--	--
A6-15-61	81361	2	11	MS35206-268	96906	3	4
A6-15-62	81361	2	3	MS35649-202	96906	2	1
A6-15-69	81361	2	2	MS51967-14	96906	3	1
A6-15-8	81361	3	6	MS51967-8	96906	1	2
A6-15-90	81361	2	9			2	6
B6-15-21	81361	3	2				
B6-15-26	81361	3	3	MS90725-6296906	1	1	

By Order of the Secretary of the Army:

W. C. Westmoreland
General, United States Army
Chief of Staff

Official

Verne L. Bowers
Major General, United States Army
The Adjutant General.

Distribution:

To be distributed with DA Form 12-28 (qty rqr block No. 62) organizational maintenance requirements for Handling and Service Equipment.

U.S. GOVERNMENT PRINTING OFFICE 1972-714-214/425
U.S. ARMY ADJUTANT GENERAL PUBLICATIONS CENTER, ST. LOUIS, MO, 1985

RECOMMENDED CHANGES TO EQUIPMENT TECHNICAL PUBLICATIONS



THEN... JOT DOWN THE DOPE ABOUT IT ON THIS FORM, CAREFULLY TEAR IT OUT, FOLD IT AND DROP IT IN THE MAIL!

SOMETHING WRONG WITH THIS PUBLICATION?

FROM: (PRINT YOUR UNIT'S COMPLETE ADDRESS)

DATE SENT

PUBLICATION NUMBER

PUBLICATION DATE

PUBLICATION TITLE

BE EXACT... PIN-POINT WHERE IT IS

PAGE NO.

PARA-GRAPH

FIGURE NO.

TABLE NO.

IN THIS SPACE TELL WHAT IS WRONG AND WHAT SHOULD BE DONE ABOUT IT:

TEAR ALONG PERFORATED LINE

PRINTED NAME, GRADE OR TITLE, AND TELEPHONE NUMBER

SIGN HERE:

DA FORM 2028-2
JUL 79

PREVIOUS EDITIONS ARE OBSOLETE.

P.S.—IF YOUR OUTFIT WANTS TO KNOW ABOUT YOUR RECOMMENDATION MAKE A CARBON COPY OF THIS AND GIVE IT TO YOUR HEADQUARTERS.

